

Mirror Digital Poster Frame 2022



unitech
digital media

Mirror



FEATURE

- Resolution: 224*756
- High refresh rate: 2880Hz
- Thickness: 35mm
- Pixel pitch: 2,5mm
- Viewing angle: 160° wide
- Frame size: 572*1902mm
- Ultra slim edge: only 6mm
- Convenient closing: hidden auto-closing

inclined bracket



Support Mobile Terminal Control

*Can be controlled by mobile
phone
application /computer/Wi-Fi
/USB connection*

LedPoster(iPoster)
can be operated by an IOS or
Android App.

**Easily change and save the
content on the display from a
phone in 10 seconds or less.**

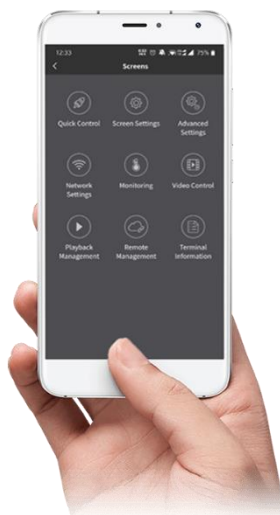

Mirror



With Mirror it's possible watching or screening video, audio or pictures playlist anytime anywhere.

With Mirror it's possible update digital content in powerful built-in media player by WIFI or USB: easy to follow on screen menu makes it absolutely simple to schedule content and no complicated configuration is needed.

Mirror is crafted in anodized aluminium, it is lightweight yet durable:
the entire poster frame weigh less than 26Kg, making it more portable and easier to install.



	P2,5mm	P1,9mm
LED type	SMD 2020	SMD 1010/1515
Pixel pitch	2,5mm	1,944mm
Led module size	210x280mm	210x280mm
Resolution (module)	84x112 (h*w)	108x144 (h*w)
LED driving method	1/28 dynamic scan	1/27 dynamic scan
LED module layout	9*2	9*2
Resolution (cabinet)	756*224	972*288
Cabinet size	1902*572*35mm	1902*572*35mm
Net. weight/set	26 Kg	26 Kg
Ingress Protection	Front IP40/Rear IP40	Front IP40/Rear IP40
Power	AC 240/100±10%	AC 240/100±10%
Serviceability	Rear service	Rear service
Max.Power consumption	500W	650W
Avg.Power consumption	150W	195W
Viewing Angle	160°/160°	160°/160°
Brightness	800~1000 nits	800~1000 nits
Pixel density	169,344 pixel/m ²	279,936 pixel/m ²
Contrast ratio	4,000:1	4,000:1
Temperature/ Humidity (Operation/Storage)	-10°C to +40°C; 10% to 90%	-10°C to +40°C; 10% to 90%
Lifetime(50% brightness)	80,000hours	80,000hours
Processing	16bit	16bit
Colors	281trillion	281trillion
Refresh rate	≥2880Hz	≥2880Hz



Mirror



MAINTENANCE

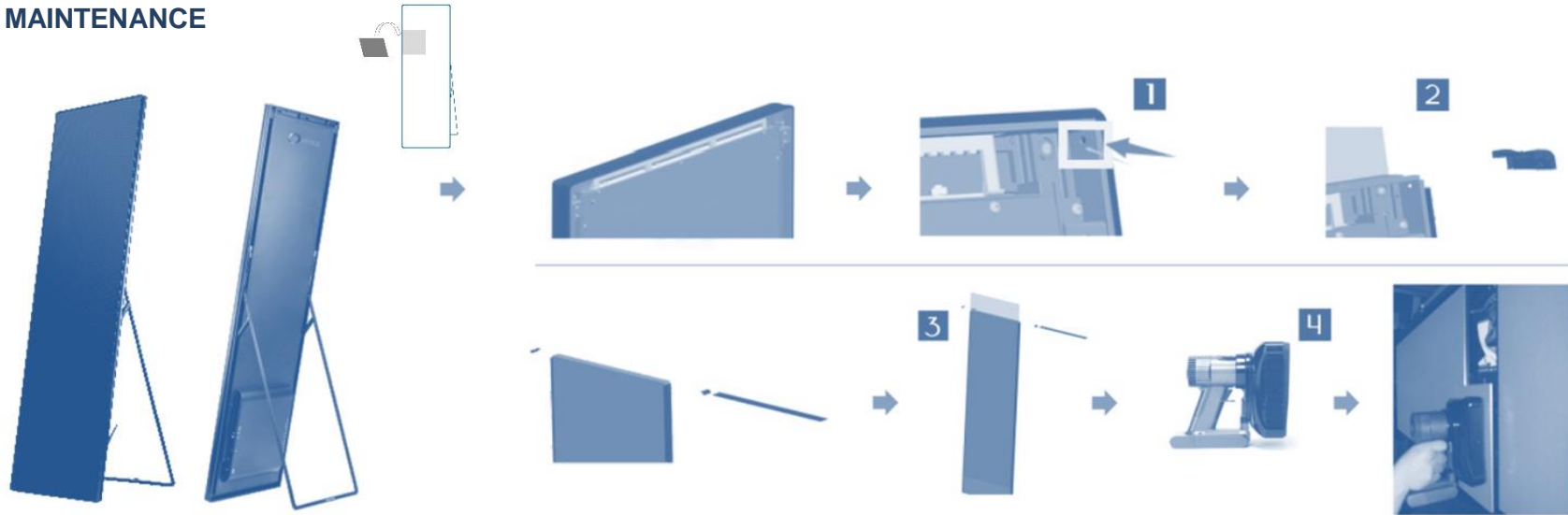

1 Remove screws

2 Remove the corner cover and top bar

3 Draw out acrylic cover from top

4 Use vacuum tools to move module from front

Mirror



1 - Scan QR code and download APP.

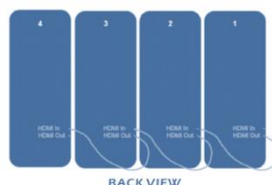

2 - Turn on power switch behind Mirror, then connect them with HDMI cables.

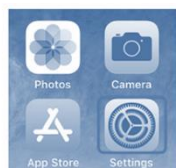

3 - Click 'setting' - 'WLAN' to find wifi ID from every Mirror, enter password.

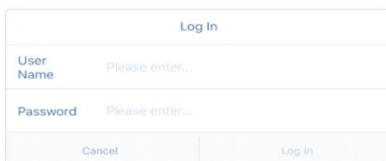

4 - Open App, login in User name and password, then click the green icon for setup.

5 - Click 'video control' - 'edit' for setting parameter.

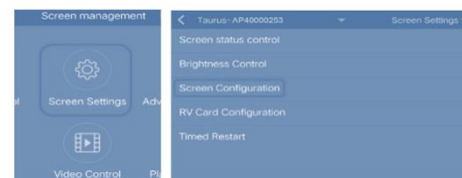

6 - Click 'screen settings' - 'screen configuration' for parameter setup.



7 - When 2 pcs Mirror are connected, only set parameter on n°1 poster - change quantity of RV card to be 2, as below. When you need to connect more than 2 pcs mirror, only set parameter on n°1 Mirror, change the quantity of RV Card to be 2, 3, 4...accordingly.



8 - As for Mirror n°2,3,4... please keep the same parameter as above. 9 - after setting, please reconnect n°1 Mirror to send contents.



10 - When you want to recover them as individual Mirror, set parameter as below.



Multiple installations

Suitable for hanging, wall-mounted, base-standing, bracket standing and creative installation.



bracket standing



base standing installation



hanging



multi-screen cascade



creative installation

Mirror

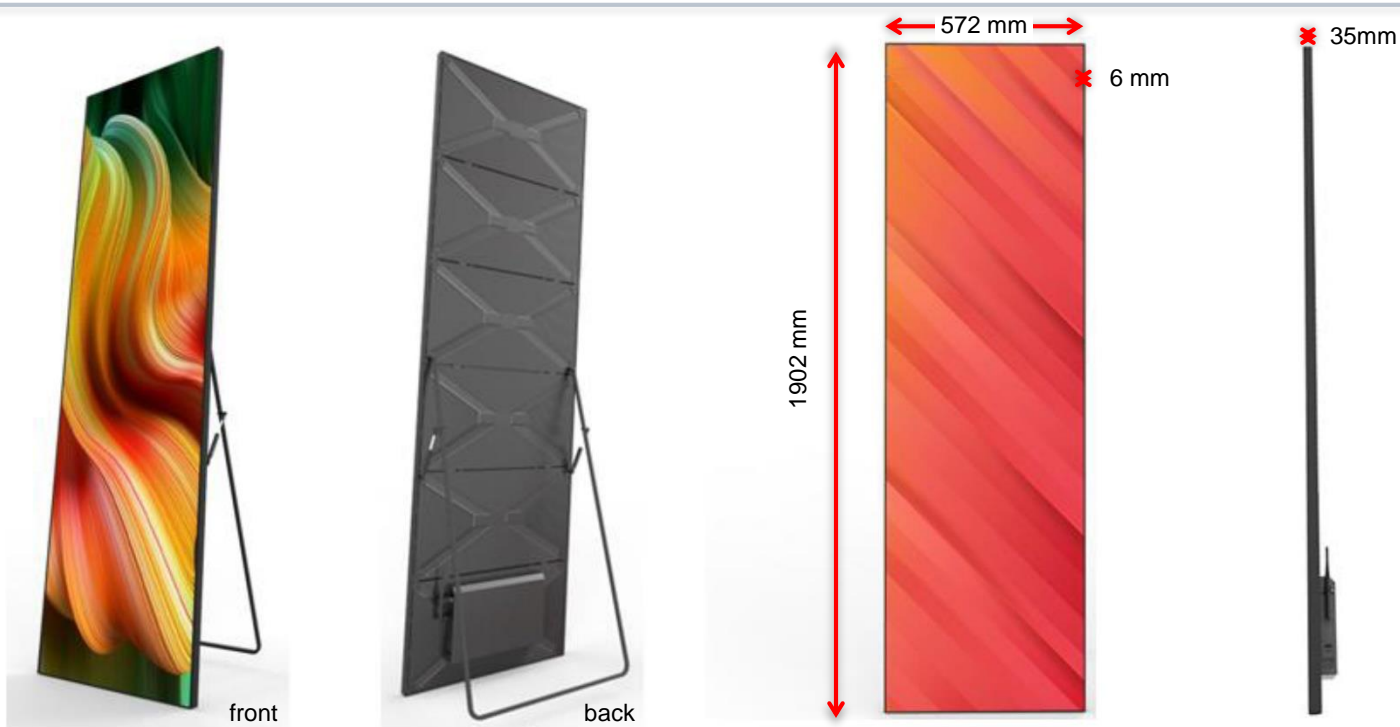

MIRROR DIGITAL POSTER FRAME

SIZE: 1902x572x35 mm

WEIGHT: 26 kg

ORDER CODE: UNIMDP1.9 - UNIMDP2.5



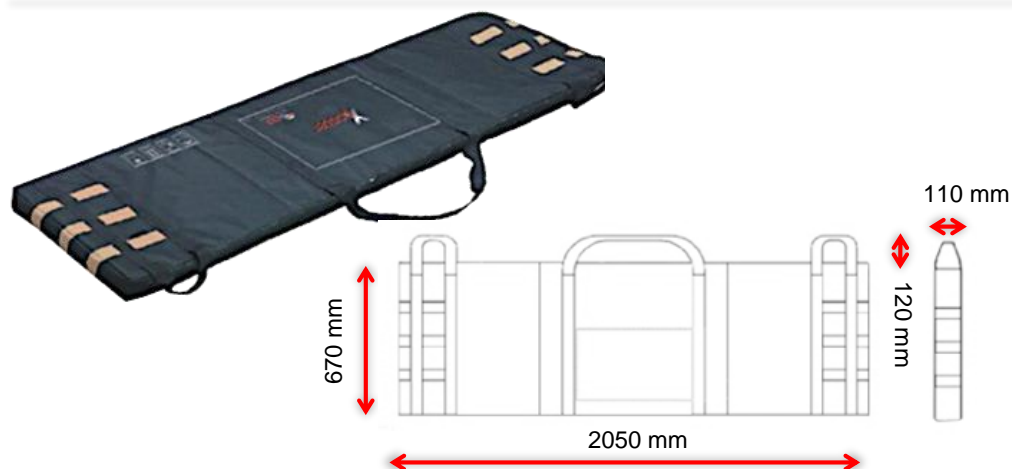

CARRIER BAG MIRROR

black canvans with reflective strips

SIZE: 2095x670x110mm

ORDER CODE: UNIMDPCB

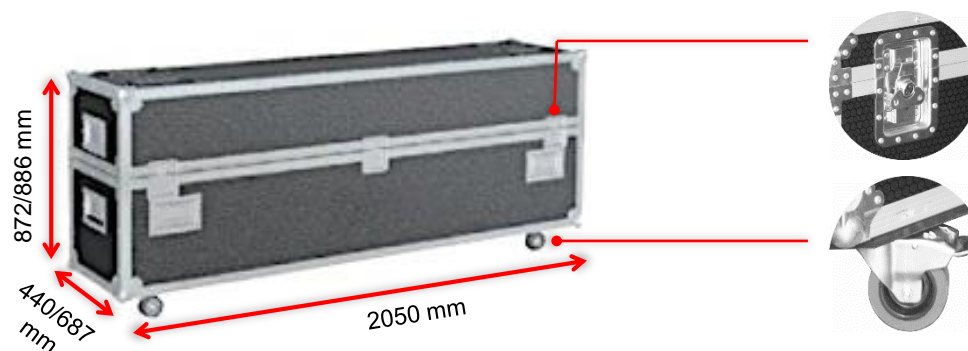

FLYCASE MIRROR

double pack

SIZE: 2095x440x872mm

ORDER CODE: UNIMDPFCD

triple pack

SIZE: 2104x687x886mm

ORDER CODE: UNIMDPFCT